



TAMPING RAMMER

PCR40R/PCR60H/PCR68H/PCR85Y SERIES



Masterpac Rammers

Masterpac four stroke rammers are perfectly balanced to deliver hard hitting compaction as well as operator comfort whilst delivering low noise and vibration to the operator.

Features

- Reliable 4-stroke engine delivers low emissions and noise
- Ingenious throttle lever for smooth operation.
- Heavy shock mount system reduces hand/arm vibration and improves operator comfort.
- Durable plastic fuel tank offers longer life and is rust free.
- Laminated timber and steel shoe absorbs and withstands vibration shock.
- Protective top frame cover eliminates possible damage to the engine.
- Innovative engine side cover protects and guards recoil starter from impact
- Convenient rollers for easy loading (PMR68H only).
- German manufactured polyurethane ribbed bellow for long life.
- Optional trolley kit for easy transportation.

Option

- Trolley kit for easy transport



Ingenious throttle lever for smooth operation.



Durable plastic fuel tank.



Innovative engine cover protects and guards recoil starter from impact.



MODEL		PCR40R	PCR60H	PCR68H	PCR85Y
Product Code		MP-PMR40R	MP-PCR60H	MP-PCR68H	MP-PCR85Y
Operating Weight	kg	46	60	68	85
Shoe Size (w x l)	mm	270X100	340X265	285 x 330	285 x 330
Jumping Stroke	mm	50-70	50-85	40-85	40-80
Impact Rate	blows/m	640-695	645-695	645-695	650-695
Impact Force (Max)	kN	12.5	10.7	12.8	18
Engine Make		Robin	Honda	Honda	Yanmar
Engine Model		EH09	GX100	GX100	L48
Max Rated Power	Hp	2.8	3	3	4.8
Fuel Type		Petrol	Petrol	Petrol	Diesel
Fuel Tank Capacity	L	2.8	2.8	2.8	2.8
Replacement Shoe				MP-80-80200	MP-80-80200
Trolley Kit (option)				MP-PCR-WK	MP-PCR-WK

Working Size (mm)

MODEL	A	B	C	D	E
PCR40R	1120	345	705	100	270
PCR60H	1063	345	703	265	340
PCR68H	1028	345	703	285	330
PCR85Y	1040	410	703	285	330

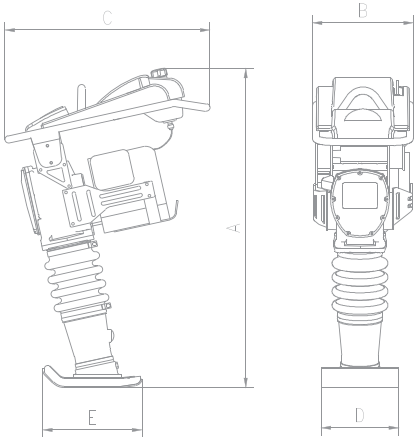

TAMPING RAMMER

PCR60HN/PCR60RN/PCR70HN/PCR70RN SERIES



Masterpac four stroke rammers are perfectly balanced to deliver hard hitting compaction as well as operator comfort,delivering low noise and vibration to the operator.



Tachometer for RPM and Hours standard.



Throttle operation with integrated engine shutoff.

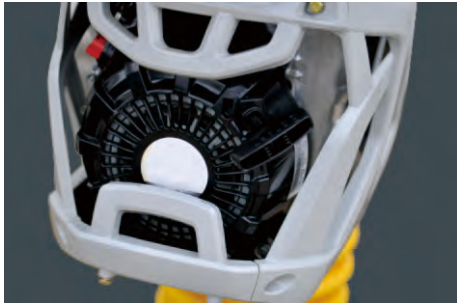

Engine protection frame with full wrap around.



Strong cyclone air filter



Optional transport wheel



Convenient roller for easy loading

Model	PCR60HN	PCR60RN
Engine Type	Honda GXR120	Robin ER12
Power kw(hp)	2.3(3.1)	2.6(3.5)
Weight kg(lb)	65(143)	65(143)
Impact Force kN	12.0	12.0
Jumping Stroke mm(in)	35-80(1.4-3.2)	35-80(1.4-3.2)
Fuel Tank L(Gal)	2.5(0.66)	2.5(0.66)
Shoe Size mm(in)	340x265(13.4x11.2)	340x265(13.4x11.2)

Model	PCR70HN	PCR70RN
Engine Type	Honda GXR120	Robin ER12
Power kw(hp)	2.3(3.1)	2.6(3.5)
Weight kg(lb)	74(163)	74(163)
Impact Force kN	13.8	13.0
Jumping Stroke mm(in)	40-85(1.6-3.4)	40-80(1.6-3.1)
Fuel Tank L(Gal)	2.5(0.66)	2.5(0.66)
Shoe Size mm(in)	340x285(13.4x11.2)	340x285(13.4x11.2)

FORWARD PLATE COMPACTOR

PC45/PC70/PC90/PC110 SERIES

Ideal for all general applications- curbs, gutters, around tanks, forms, columns, footings, landscaping, paving blocks, drainage ditches, and light to medium road repair work.



Model	A	B	C	D
PC45	838/33	1102/43.4	470/18.5	290/11.4
PC70	1010/39.7	910/35.8	531/20.9	360/14.2
PC90	1045/41.1	919/36.2	568/22.4	400/15.7
PC110	1050/41.3	920/36.2	570/22.4	500/19.7

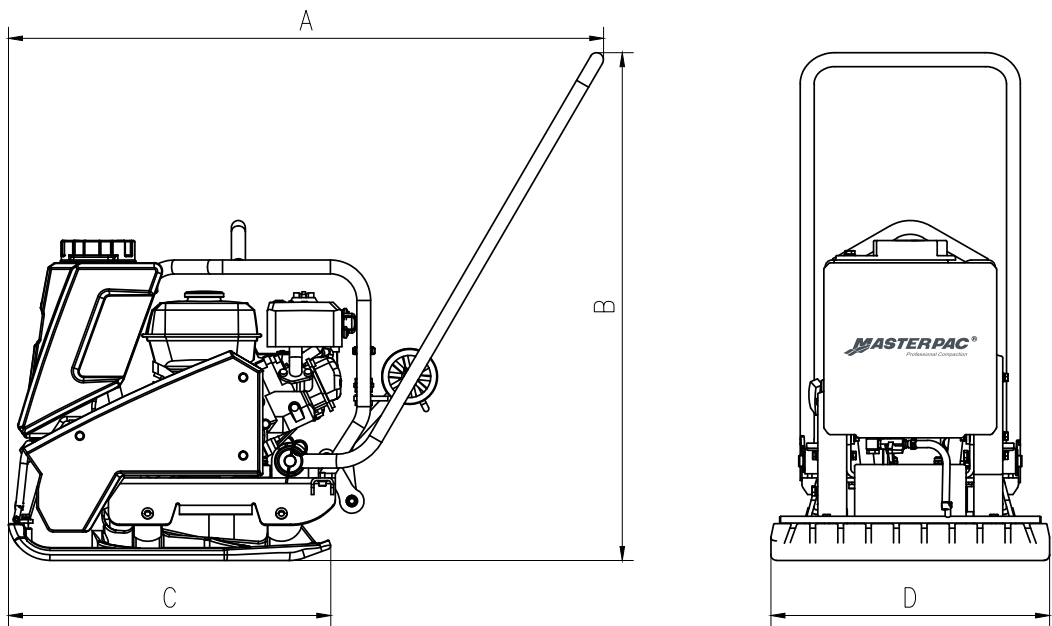

Technical Specification

Model	PC45	PC70H PCV70H	PC90H PCV90H	PC110H PCV110H
Engine Type	Robin EH09	Honda GX120	Honda GX160	Honda GX160
Power kw(hp)	1.5(2.0)	2.4(3.3)	3.6(4.9)	3.6(4.9)
Weight kg(lb)	45(99)	62(137)	85(187)	102(225)
Plate Size L X W cm(in)	4x29(18.5x11.4)	50x36(21x14)	57x40(22x16)	57x50(22x20)
Centrifugal Force kN	7.5	10	15	20
Vibration Frequency vpm(Hz)	100		95	
Travel Speed m/min(ft/min)	25(82)		25(82)	

HYDRAULIC REVERSIBLE PLATE COMPACTOR



PCR3820H/PCR4025H/PCR5030H/PCR6040H/PCR6040L
/PCR6040Y/PCR7060L/PCR7060Y SERIES



PCR4025

PCR6040

PCR7060

Masterpac Reversible Plate Compactors

Masterpac reversible plate compactors are ideal for high production and efficient compaction of sand, gravel and cohesive soils in trenches and large construction projects.

Features

- Hydraulic adjustment control lever for easy direction change.
- User friendly vibration isolated handles.
- Fully sealed lubricated wear resistant cast iron vibrator assembly.
- On the spot compaction for problem areas.
- Handle folds to 90 degree position for ease of transportation.
- Infinitely variable hydrostatic forward and reverse motion.
- Reverse travel safety protection ensure the plate automatically reverts to slow forward travel if the operator releases the travel control lever while reversing.
- Impact-resistant and open self cleaning base plate.
- Unique built-in transport wheels provides easy transportation (PCR4025H only).
- Convenient oil drain hose.

Working Size (mm)

MODEL	A	B	C	D
PCR3820H	1155	1000	580	380
PCR4025H	1245	1008	650	400
PCR5030H	1268	1010	695	500
PCR6040H	1540	1047	900	600
PCR6040L	1540	1047	900	600
PCR7060L	1585	1040	900	708

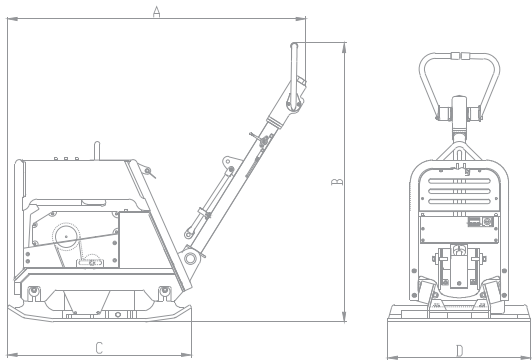

MODEL		PCR3820H	PCR4025H	PCR5030H	PCR6040H
Product Code		MP-PCR3820H	MP-PCR4025H	MP-PCR5030H	MP-PCR6040H
Operating Weight	kg	110	145	171	355
Plate Size (w x l)	mm	580x380	400 x 650	690x500	900x600
Centrifugal Force (Max)	kN	20	25	30	40
Vibration Frequency	VPM	5400	5400	5400	4140
Max Travel Speed	m/min	22	22	20	20-24
Max Gradeability	%	30	30	30	30
Max Compacted Area	m²/h	528	528	864	864
Engine Make		Honda	Honda	Honda	Honda
Engine Model		GX160	GX160	GX200	GX270
Max Rated Power	Hp	5.5	5.5	6.5	9
Fuel Type		Petrol	Petrol	Petrol	Petrol

MODEL		PCR6040L	PCR6040Y	PCR7060L	PCR7060Y
Product Code		MP-PCR6040L	MP-PCR6040Y	MP-PCR7060L	MP-PCR7060Y
Operating Weight	kg	375	375	465	465
Plate Size (w x l)	mm	600 x 900	600x900	900x700	900x700
Centrifugal Force (Max)	kN	40	40	60	60
Vibration Frequency	VPM	4140	4140	4140	4140
Max Travel Speed	m/min	20-24	20-24	20-25	20-25
Max Gradeability	%	30	30	30	30
Max Compacted Area	m²/h	864	864	864	864
Engine Make		Kohler	Yanmar	Kohler	Yanmar
Engine Model		15LD440	L100N	15LD440	L100N
Max Rated Power	Hp	11	10.2	11	10.2
Fuel Type		Diesel	Diesel	Diesel	Diesel

SINGLE DRUM VIBRATORY ROLLER

SVR58 SERIES

Masterpac single drum roller is lightweight and maneuverable for compaction of granular and asphalt applications, ideally suited to smaller repair and maintenance jobs such as footpath, bridges, patching, landscaping applications.



Technical Specification

Model	SVR58H	SVR58R
Engine Type	Honda GX160	Robin EX17
Power kw(hp)	3.6(4.9)	2.9(4.0)
Weight kg(lb)	185(408)	
Drum Diameter mm(in)	580 x Ø400(23 x Ø16)	
Centrifugal Force kN	10	
Static Linear Force N/cm	28.5	
Frequency vpm(Hz)	4560(76)	
Travel Speed m/min	0-50	
Water tank capacity L(US gal)	15(3.96)	



Features

- Hydraulic system provides variable working speed.
- DEADMAN CONTROL and REVERSING PROTECTION for maximum operator safety.
- Easy reach controls for operator comfort.
- Ergonomically designed height-adjustable handle for operator comfort and simplified transport
- Self-cleaning scrapers prevent the buildup of dirt.
- Beveled drum edge eliminates markings on surface.
- SIDE and CURB CLEARANCE allow for the closest approach to pavement, wall, curb and other obstacle.
- Compact design for easy handling in confined areas.
- Thick drum shells for longer drum life.
- Large corrosion-free water tank feature in easily removable for filling or cleaning.
- Built-in cooling fan is designed for longer life and continuous operation.



Deadman control and reversing protection.



Variable height adjustment for operator's comfort.



Narrow overhang for operation close to walls and curbs.



Thick drum shells for longer drum life.



Beveled drum edge.

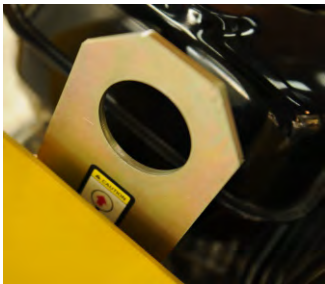

Lifting hook.

DOUBLE DRUM VIBRATORY ROLLER

DVR65L/DVR65A/DVR65Y SERIES

Masterpac walk behind rollers are designed rugged and suitable for a wide range of applications in the construction industry. The rollers deliver excellent compaction to all types of gravel and asphalt surfaces for large and confined areas.



Features

MASTERPAC DVR65, different from most chain or belt driven roller on the market, comes with a fully hydraulic-drive system that consists of hydraulic pump and motors not only on vibration but also movement, eliminating the need for regular periodic adjustments and changes while providing variable working speed.

- DEADMAN CONTROL lever offers REVERSING PROTECTION.
- Mechanical parking brake.
- Multi position handle for operator comfort and simplified transport.
- Built-in oil cooler will increase the productivity of machine.
- Ergonomically designed handle lever is conveniently positioned to ensure speed and vibration.
- Anti vibration controls ensure non-fatiguing and low HAV (Hand/Arm Vibration) for the operator.
- The SIDE and CURB CLEARANCE allows for the closest possible approach to pavements, curbs, walls and other obstacles.
- Dual smooth drums with beveled edge eliminates mark on the ground and asphalt.
- Easy access to front mounted Diesel engine.
- 65 Liter, corrosion-free water tank mounted at the rear of roller reduces sound and keeps dust to a minimum.
- Two scraper bars on each drum ensure a clean drum when working on asphalt.
- Minimum overhang offers suitable side and curb clearance.
- Unique CLUTCH/PUMP drive system provides easy cold weather starting and allows for no-load starting of engine.

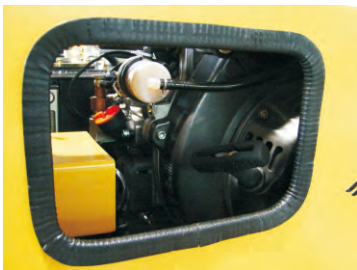

Engine choice of LOMBARDINI and HATZ



Electric starter is an option



Sturdy protected throttle control



Minimum overhang offer side clearance and curb clearance.



Ergonomically design handle with deadman control and reversing protection.

Technical Specification

Model	DVR65L	DVR65A	DVR65Y
Engine Type	Lombardini 15LD440	Hatz 1B40	Yanmar L100N
Power kw(hp)	7.5(10.2)	7.3(9.9)	7.5(10.2)
Weight kg(lb)	718(1583)	721(1590)	718(1583)
Drum Diameter mm(in)	650 x ø404(25. 6 x ø16)		
Static Linear Force N/cm	54		
Centrifugal Force kN	21		
Frequency vpm(Hz)	3300(55)		
Travel Speed km(ml)/h	0-3.6(0-2.2)		
Water tank capacity L(US gal)	65(17)		

WALK-BEHIND DOUBLE DRUM ROLLER



DVRS65 SERIES

DVRS65 is a vibratory roller with hydraulic-controlled movement , ideal for applications of asphalt, soil and granular material compaction. Its compact design makes it perfect in the jobs on curbs & sides and in confined areas.



Features:

- Deadman control lever offers reversing protection.
- Mechanical parking brake.
- Ergonomically designed handle lever.
- Side and Curb clearance allow for the closest approach to curbs walls and other obstacles.
- Dual smooth drums with beveled edges eliminate marks on ground and asphalt.
- Low maintenance and easy accessible diesel engine.
- 40L corrosion-free water tank.
- Two scraper bars ensure a clean drum.
- High-quality hydraulic pumps and motors.



Ergonomically designed handle lever



Side and Curb clearance allow for the closest approach to curbs walls and other obstacles

Technical Specification

Model	DVRS65L	DVRS65H	DVRS65P	DVRS65K
Engine Type	LOMBARDINI 15LD350	HONDA GX390	KIPOR KM186F	KUBOTA E75-NB3
Power kw(hp)	5.5(7.5)	8.7(11.8)	6.3(8.6)	4.6(6.3)
Weight kg(lb)	640(1411)	625(1378)	630(1389)	650(1433)
Drum Diameter mm(in)	650 x ø402(25.6 x ø16)			
Statistic Linear Force N/cm	51			
Centrifugal Force kN	11.3			
Frequency vpm(Hz)	3300(55)			
Travel Speed km(ml)/h	0-3.6(2-2.4)			
Water tank capacity L(US gal)	40(10.6)			
Dimension mm(in)	2378X696X1130(94x27x44)			

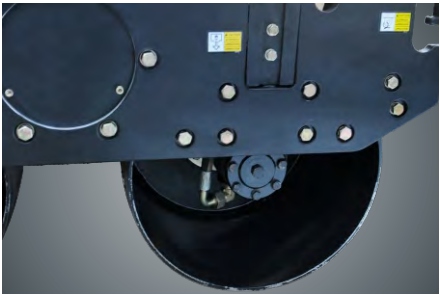

Hydraulic Pump



Hydraulic Motor

ARTICULATED TANDEM ROLLER

PDR90 SERIES



Masterpac PDR90H Articulated Tandem Roller is suitable for compaction of asphalt, compaction of non-cohesive and cohesive soil and compaction of stabilized soils. It is used primarily for small-scale compaction work such as pavements, cycle paths, small roads and small parking areas- places that need compaction but are difficult to reach with a larger roller.

Features:

- Articulated movement with power-assist provides accurate, positive steering control and increases maneuverability in confined job sites.
- The hydraulic pump and motors are connected in series to offer the maximum traction and smooth rolling as well as excellent gradeability.
- 40mm side clearance allows close operations near walls and obstructions.
- Curb clearance 415mm insures flush compaction to the curb.
- Unobstructed driver visibility—open, uncluttered operator's platform allows clear views.
- A spacious, vibration-damped operator platform and an ergonomically positioned step make the machine extremely operator-friendly.
- Flip-open engine hood provides easy accessibility to engine and components for daily maintenance and service.
- Ergonomic layout and design of the operating controls: the Easy Drive steering wheel, multifunctional control lever, and comfortable armrests.
- Large 100L water tank is equipped with pressurized water system offers consistent water flow.

Technical Specification

Model	PDR90H	PDR90K
Net Weight(Kgs/Lb)	1354/2985	1430/3153
Operating weight(Kgs/Lb)	1529/3371	1575/3472
Engine Type	HONDA GX690	KUBOTA D902-E3B
Power (Kw)	15.5kw	18.5 kw
Drum width (mm/in)	900/35.4	
Drum diameter (mm/in)	560/22	
Number of vibrating drums	1/Front wheel	2/Front and rear wheels
Driving system	Hydraulic	
Number of driving drums	2/Front and rear wheels	
Dynamic Centrifugal force per drum (kN)	18	
Frequency (Hz)	60	
Amplitude (mm/in)	0.5/0.02	
Dynamic linear force	83N/CM (Front wheel)	
Forward/reverse speed	0-8.7	
Maximum gradeability	30%	
Turning radius	2.3m(inside)	
Steering angle	±30°	
Hydraulic oil tank capacity(L/ US gal)	37 / 9.8	
Water tank capacity(L/ US gal)	100 / 26.4	
Fuel tank capacity (L/ US gal)	30 / 7.9	
Light	2(Front) ,2(Back),Warning lamp(Overhear)	
Tracting device	Front and rear	
Side clearance (R/L)	40/40mm(R/L)	
Curb clearance (R/L)	415/415(R/L)	
Dimension (mm/In)	2019x994x2308(1730)/79x39x91(68)	



Big drum diameter makes compaction easier even on soft tricky asphalt mixes and thick drum shells for longer life-span



Clean and ergonomic layout of dashboard , variable height adjustment of steering minimizing operator fatigue



Articulated steering with a maintenance-free hitch and steering cylinder reduces maintenance



Ergonomic adjustable seat for maximizing the operator comfort